

# Ring sizes

Determine your ring size

# NOVA

SUPERB

## RING SIZES TABLE

1. Take an existing ring and measure the inside diameter
2. Compare it with the following table of dimensions and define the order size

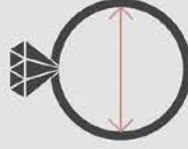

Inside diameter in mm	14.5	15.3	15.9	16.6	17.2	17.8	18.5	19.1	19.7	20.4	21
Order size	<b>46</b>	<b>48</b>	<b>50</b>	<b>52</b>	<b>54</b>	<b>56</b>	<b>58</b>	<b>60</b>	<b>62</b>	<b>64</b>	<b>66</b>

## RING SIZE TEMPLATE

1. Print this page in landscape format on A4 paper. Do not select print adjustment in the page settings so that the page is printed in its original size.
2. Place an existing ring on the matching circle. The outer line must be visible inside the ring OR fold the sheet at the dotted line (center of the circle) and cut out the semicircles at the outer line. Now check which order size (46-66) fits your finger.

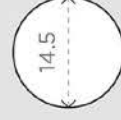

**46**

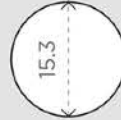

**48**

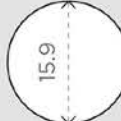

**50**

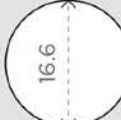

**52**

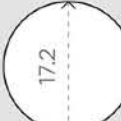

**54**

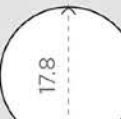

**56**

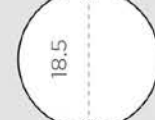

**58**

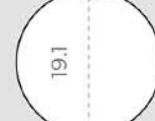

**60**



**62**

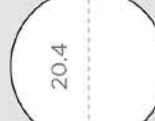

**64**

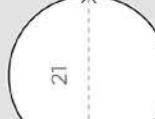

**66**



Controlstrip This line **must be 10 cm long**



# NOVA

SUPERB

Inside diameter (mm)	Ring size Germany (circumference)	Ring size USA/Canada (US ring size)	Ring size Great Britain (UK ring size)	Ring size France (taille de bague)	Ring size Japan
12.7	40	1.4 (1)	C	0.0	0.2
13.0	41	1.8 (1-)	C 1/2	1.0	1.1
13.4	42	2.2 (2)	D 1/2	2.0	2.1
13.7	43	2.6 (2-)	E 1/2	3.0	3.1
14.0	44	3.0 (2-)	F	4.0	4.0
14.3	45	3.4 (3)	G	5.0	5.0
14.6	46	3.7 (3-)	G 1/2	6.0	5.9
15.0	47	4.1 (4)	H 1/2	7.0	6.9
15.3	48	4.5 (4-)	I 1/2	8.0	7.8
15.6	49	4.9 (4-)	J	9.0	8.8
15.9	50	5.3 (5)	K	10	9.7
16.2	51	5.7 (5-)	K 1/2	11	10.7
16.6	52	6.1 (6)	L 1/2	12	11.6
16.9	53	6.4 (6)	M 1/2	13	12.6
17.2	54	6.8 (6-)	N	14	13.6
17.5	55	7.2 (7)	O	15	14.5
17.8	56	7.6 (7-)	P	16	15.5
18.1	57	8.0 (7-)	P 1/2	17	16.4
18.5	58	8.4 (8)	Q 1/2	18	17.4
18.8	59	8.7 (8-)	R	19	18.3
19.1	60	9.1 (9)	S	20	19.3
19.4	61	9.5 (9-)	T	21	20.2
19.7	62	9.9 (9-)	T 1/2	22	21.2
20.1	63	10.3 (10)	U 1/2	23	22.2
20.4	64	10.7 (10-)	V	24	23.1
20.7	65	11.0 (11)	W	25	24.1
21.0	66	11.4 (11)	X	26	25.0
21.3	67	11.8 (11-)	X 1/2	27	26.0
21.6	68	12.2 (12)	Y 1/2	28	26.9
22.0	69	12.6 (12-)	Z 1/2	29	27.9
22.3	70	13.0 (12-)	Z +1	30	28.8